

STOPPLE® Fittings

150 and 300 ANSI



Bulletin No: 1100.001.08

Version 09.2023

Supersedes: 1100.001.07 (10.2021)

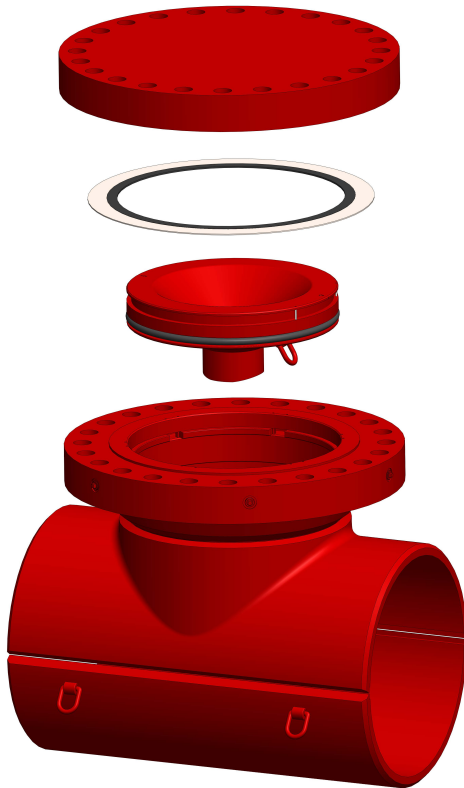

STOPPLE® Fitting

Back-up strips are standard and provided for all fittings.

All pressure-containing welds on the fittings have undergone X-ray inspection per ASME and API requirements.

Fitting sleeves are manufactured from a pressure-vessel quality, normalized, and killed carbon steel plate with a hardness below 22 HRC.

The charpy impact value of the sleeves at -58°F (-50°C) is 28 J min/ 37 J min-avg and a maximum carbon equivalency of 0.43.

Option

Flow-through LOCK-O-RING with guide bars is available to maintain pigability for hot tap only applications.

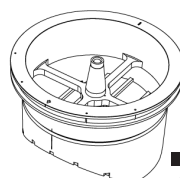

Flow-through LOCK-O-RING® assembly with guide bars

Description

STOPPLE® Fittings are full-branch split tees designed for use with TDW plugging machines or for completing size-on-size hot taps.

They meet ASME B31.3/B31.4/B31.8 and CSA Z662 CAT I specifications for use in piping, pipeline transportations and gathering systems for liquid, gas hydrocarbons and other fluids, as well as refining locations.

STOPPLE fittings are furnished with LOCK-O-RING® flanges to accept LOCK-O-RING® completion plugs, respectively, permitting removal of the tapping valve after work is completed.

Features

Flange-to-sleeve weld-joints and sleeves are designed to meet pressure and reinforcement requirements of ASME codes. STOPPLE Fittings are furnished with LOCK-O-RING® Flanges drilled and faced to match ASME flanges.

Typical Tapping Setup For Plugging Operation

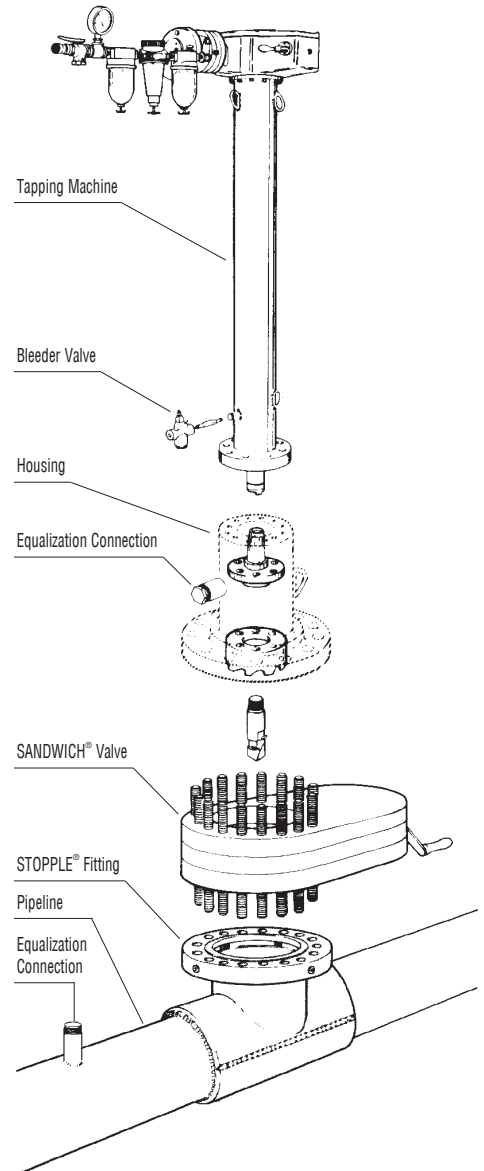



STOPPLE® Fittings

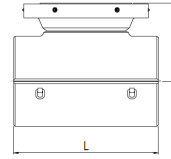

1100.001 - pg.2

ASME Class 150

Size		Weight		Dimension L		Dimension H		Design Factor					Part Number
Inches	DN	lbs	Kgs	in.	mm	in.	mm	B31.3	0.4	0.5	0.6	0.72	
4"	100	46	21	11	273	7	168	285	285	285	285	285	06-8921-0415-00
6"	150	80	36	14	356	8	206	285	285	285	285	285	06-8921-0615-00
8"	200	125	57	17	419	10	246	285	285	285	285	285	06-8921-0815-00
10"	250	195	89	20	508	11	286	285	285	285	285	285	06-8921-1015-00
12"	300	305	139	22	559	13	329	285	285	285	285	285	06-8921-1215-00
14"	350	410	186	26	660	14	354	285	250	285	285	285	06-8921-1415-00
16"	400	565	257	30	762	16	403	285	285	285	285	285	06-8921-1615-00
20"	500	969	440	36	914	18	456	285	200	250	285	285	06-8921-2015-00
24"	600	1650	750	43	1092	21	521	275	185	225	275	285	06-8921-2415-00
30"	750	2915	1325	56	1422	30	768	285	225	285	285	285	06-8921-3015-00

Dimensions are reference only. For actual dimensions please consult factory.
For sizes not listed consult factory

Variable pressure across fittings for ASME B31.3

Maximum allowable operating pressure ASME B31.8/.72 285PSI AT -20°F TO +100°F

Maximum allowable operating pressure ASME B31.4/.72 285PSI AT -20°F TO +100°F

Maximum allowable operating pressure CSA Z662 CAT I/.72 285PSI AT -20°F TO +100°F

ASME Class 300

Size		Weight		Dimension L		Dimension H		Design Factor					Part Number
Inches	DN	lbs	Kgs	in.	mm	in.	mm	B31.3	0.4	0.5	0.6	0.72	
4"	100	60	27	11	273	7	167	740	740	740	740	740	06-8921-0430-00
6"	150	74	34	14	356	8	212	740	600	740	740	740	06-8921-0630-00
8"	200	115	52	17	419	10	248	740	425	550	650	740	06-8921-0830-00
10"	250	195	89	20	508	11	286	740	500	625	740	740	06-8921-1030-00
12"	300	290	132	22	559	13	329	740	500	625	740	740	06-8921-1230-00
14"	350	255	116	26	660	14	354	740	525	650	740	740	06-8921-1430-00
16"	400	570	259	30	762	16	403	740	550	675	740	740	06-8921-1630-00
18"	450	685	311	33	838	17	435	700	600	740	740	740	06-8921-1830-00
20"	500	985	448	36	914	18	468	600	475	600	740	740	06-8921-2030-00
22"	550	1450	659	40	1016	19	491	475	425	525	625	740	06-8921-2230-00
24"	600	1700	773	43	1092	22	557	625	500	625	740	740	06-8921-2430-00
26"	650	2100	955	50	1270	26	666	650	500	625	740	740	06-8921-2630-00
30"	750	3000	1364	56	1422	30	768	450	425	525	600	740	06-8921-3030-00
36"	900	3900	1773	65	1651	29	738	625	470	575	700	740	06-8921-3630-00

Dimensions are reference only. For actual dimensions please consult factory.
For sizes not listed consult factory.

Variable pressure across fittings for ASME B31.3

Maximum allowable operating pressure ASME B31.8/.72 740PSI AT -20°F TO +100°F

Maximum allowable operating pressure ASME B31.4/.72 740PSI AT -20°F TO +100°F

Maximum allowable operating pressure CSA Z662 CAT I/.72 740PSI AT -20°F TO +100°F