

STOPPLE® Fittings

150, 300 ANSI and Reduced Branch Split Tees



Bulletin No: 1100.001.07

Version 10.2021

Supersedes: 1100.001.06 (07.2018)

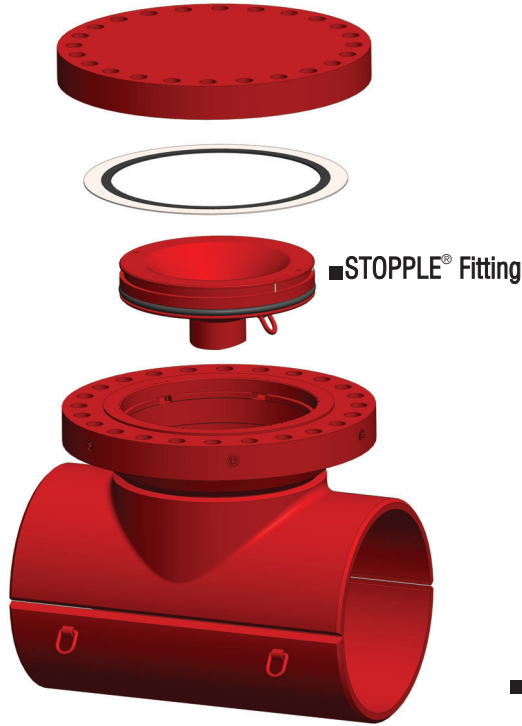

■ Reduced Branch Split Tee with LOCK-O-RING® Flange

Description

STOPPLE® Fittings are full-branch split tees designed for use with TDW plugging machines or for completing size-on-size hot taps requiring guide bars to maintain piggability. STOPPLE Fittings are furnished with LOCK-O-RING® Flanges drilled and faced to match ASME flanges.

Extruded reduced branch split tee fittings are furnished with LOCK-O-RING Flanges with the option of flow through rings with guide bars to maintain piggability of the line.

Features

Factory welding of TDW STOPPLE fittings and reduced branch split tee fittings is 100% radiographically inspected at all TDW manufacturing plants except Nivelles, Belgium, where 100% ultrasonic examination is used.

Option

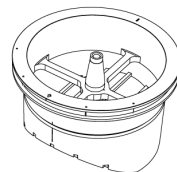

■ Flow through LOCK-O-RING® assembly with guide bars

Typical Tapping Setup For Plugging Operation

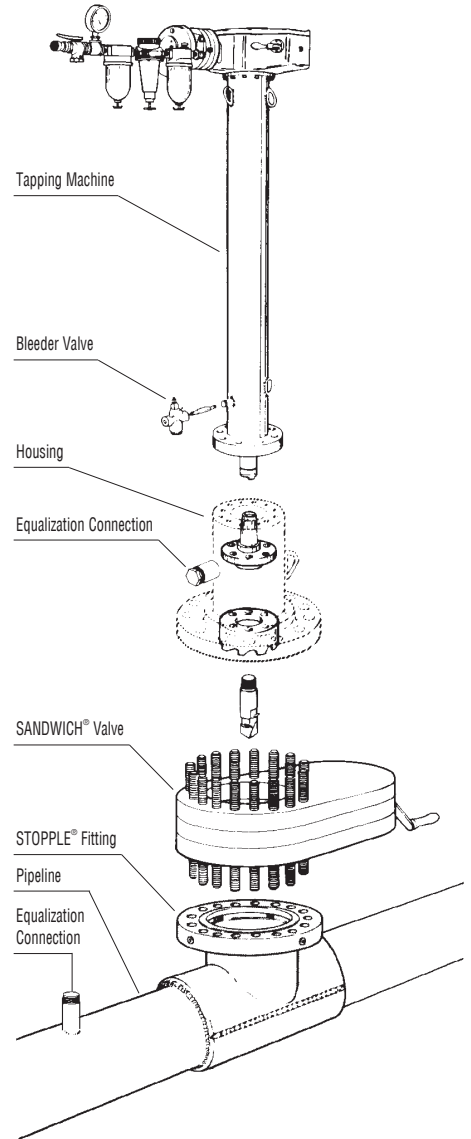



STOPPLE® Fittings

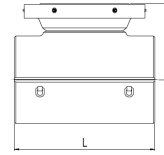

ASME Class 150

Size		Weight		Dimension L		Dimension H		Design Factor					Part Number
Inches	DN	lbs	Kgs	in.	mm	in.	mm	B31.3	0.4	0.5	0.6	0.72	
4"	100	46	21	11	273	7	168	285	285	285	285	285	06-8921-0415-00
6"	150	80	36	14	356	8	206	285	285	285	285	285	06-8921-0615-00
8"	200	125	57	17	419	10	246	285	285	285	285	285	06-8921-0815-00
10"	250	195	89	20	508	11	286	285	285	285	285	285	06-8921-1015-00
12"	300	305	139	22	559	13	329	285	285	285	285	285	06-8921-1215-00
14"	350	410	186	26	660	14	354	285	250	285	285	285	06-8921-1415-00
16"	400	565	257	30	762	16	403	285	285	285	285	285	06-8921-1615-00
20"	500	969	440	36	914	18	456	285	200	250	285	285	06-8921-2015-00
24"	600	1650	750	43	1092	21	521	275	185	225	275	285	06-8921-2415-00
30"	750	2915	1325	56	1422	30	768	285	225	285	285	285	06-8921-3015-00

Dimensions are reference only. For actual dimensions please consult factory.
 For sizes not listed consult factory
 Variable pressure across fittings for ASME B31.3/.72
 Maximum allowable operating pressure ASME B31.8/.72 285PSI AT -20°F TO +100°F
 Maximum allowable operating pressure ASME B31.4/.72 285PSI AT -20°F TO +100°F
 Maximum allowable operating pressure CSA Z662 CAT I/.72 285PSI AT -20°F TO +100°F

ASME Class 300

Size		Weight		Dimension L		Dimension H		Design Factor					Part Number
Inches	DN	lbs	Kgs	in.	mm	in.	mm	B31.3	0.4	0.5	0.6	0.72	
4"	100	60	27	11	273	7	167	740	740	740	740	740	06-8921-0430-00
6"	150	74	34	14	356	8	212	740	600	740	740	740	06-8921-0630-00
8"	200	115	52	17	419	10	248	740	425	550	650	740	06-8921-0830-00
10"	250	195	89	20	508	11	286	740	500	625	740	740	06-8921-1030-00
12"	300	290	132	22	559	13	329	740	500	625	740	740	06-8921-1230-00
14"	350	255	116	26	660	14	354	740	525	650	740	740	06-8921-1430-00
16"	400	570	259	30	762	16	403	740	550	675	740	740	06-8921-1630-00
18"	450	685	311	33	838	17	435	700	600	740	740	740	06-8921-1830-00
20"	500	985	448	36	914	18	468	600	475	600	740	740	06-8921-2030-00
22"	550	1450	659	40	1016	19	491	475	425	525	625	740	06-8921-2230-00
24"	600	1700	773	43	1092	22	557	625	500	625	740	740	06-8921-2430-00
26"	650	2100	955	50	1270	26	666	650	500	625	740	740	06-8921-2630-00
30"	750	3000	1364	56	1422	30	768	450	425	525	600	740	06-8921-3030-00
36"	900	3900	1773	65	1651	29	738	625	470	575	700	740	06-8921-3630-00

Dimensions are reference only. For actual dimensions please consult factory.
 For sizes not listed consult factory.
 Variable pressure across fittings for ASME B31.3/.72
 Maximum allowable operating pressure ASME B31.8/.72 740PSI AT -20°F TO +100°F
 Maximum allowable operating pressure ASME B31.4/.72 740PSI AT -20°F TO +100°F
 Maximum allowable operating pressure CSA Z662 CAT I/.72 282PSI AT -20°F TO +100°F



Reduced Branch Split Tees

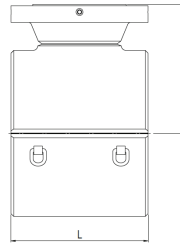

0.72 Reducing Branch Split Tees with LOCK-O-RING® Flanges

ASME CLASS 600

Size Inches	Weight		Dimension L		Dimension H		0.5	0.6	0.72	Part Number
	lbs	Kgs	in.	mm	in.	mm				
6x4	75	34	11	273.05	8	203	1320	1480	1480	06-8812-0604-17
8x4	85	39	11	273	9	229	1095	1315	1480	06-8812-0804-17
8x6	110	50	14	356	10	254	1035	1240	1480	06-8812-0806-17
10x6	140	64	14	356	11	279	1105	1325	1480	06-8812-1006-17
10x8	210	95	17	419	12	305	1100	1320	1480	06-8812-1008-17
16x8	270	122	15	378	15	381	1090	1310	1480	06-8812-1608-17
16x12	490	222	24	610	16	406	1095	1270	1480	06-8812-1612-17
20x12	565	256	24	610	18	457	1060	1270	1480	06-8812-2012-17
24x12	790	358	21	543	20	508	1115	1335	1480	06-8812-2412-17
24x16	1200	544	30	762	21	533	1235	1480	1480	06-8812-2416-17
24x20	1545	701	36	914	23	584	1150	1380	1480	06-8812-2420-17
30x24	2400	1089	43	1092	27	681	1010	1215	1480	12372232

Dimensions are reference only. For actual dimensions please consult factory.

For sizes not listed consult factory.

Maximum allowable operating pressure ASME B31.3/72 915PSI AT -20°F TO +250°F

Maximum allowable operating pressure ASME B31.4/72 1480PSI AT -20°F TO +100°F

Maximum allowable operating pressure ASME B31.8/72 1480PSI AT -20°F TO +100°F

Maximum allowable operating pressure CSA Z662 CAT II/72 1480PSI AT -50°F TO +100°F

0.50 Reducing Branch Split Tees with LOCK-O-RING® Flanges

ASME CLASS 600

Size Inches	Weight		Dimension L		Dimension H		B31.3	0.5	0.6	0.72	Part Number
	lbs	Kgs	in.	mm	in.	mm					
6x4	45	20	11	273	9	223	1480	1480	1480	1480	36-2050-0604-30
8x4	111	50	11	273	10	252	1480	1480	1480	1480	36-2050-0804-30
8x6	161	73	14	356	10	266	1480	1480	1480	1480	36-2050-0806-30
10x4	145	66	11	273	11	284	1480	1480	1480	1480	36-2050-1004-30
10x6	200	91	14	356	12	297	1480	1480	1480	1480	36-2050-1006-30
10x8	270	122	17	419	12	316	1480	1480	1480	1480	36-2050-1008-30
12x4	175	79	11	273	12	316	1480	1480	1480	1480	36-2050-1204-30
12x6	245	111	14	356	13	328	1480	1480	1480	1480	36-2050-1206-30
12x8	320	145	17	419	14	348	1480	1480	1480	1480	36-2050-1208-30
12x10	420	191	20	508	15	375	1480	1480	1480	1480	36-2050-1210-30

Dimensions are reference only. For actual dimensions please consult factory.

For sizes not listed consult factory.

Maximum allowable operating pressure ASME B31.8/5 1480PSI AT -20°F TO +100°F

Maximum allowable operating pressure ASME B31.4/5 1480PSI AT -20°F TO +100°F

Maximum allowable operating pressure CSA Z662 CAT II*/5 1480PSI AT -20°F TO +100°F

Maximum allowable operating pressure ASME B31.3 1480PSI AT -20°F TO +100°F

Compliant with NACE MR0175

*CAT II with conditions. Class 1 not lower than -49°F, Class 2 not lower than -64°F, NPS 24 and larger require Charpy.



1100.001.07 - pg.4