



- Optional completion plugs with piggable guide bars
- Time-tested TDW quality
- Eliminates buried flanges
- Welds directly to valve

## Double-Hub Fitting

with LOCK-O-RING® Flange

**Make a direct connection** to your valves and eliminate underground flanges with the Double-Hub Fitting from TDW. Specifically engineered for transmission pipeline applications, the Double-Hub Fitting provides the TDW quality you trust, while reducing the number of potential underground leak paths typical of low-profile connection systems. The Double-Hub Fitting is designed to ASME B31.3, B31.4 and B31.8 specifications.



Pipeline Performance™

T.D. Williamson, Inc.

# Double-Hub Fitting with LOCK-O-RING® Flange



Double-Hub Assembly to perform the pressure test.

A Double-Hub assembly is manufactured using a forged ring. In order to allow for a hydrostatic pressure test, a pup piece with end caps is welded to each side of the Double-Hub assembly. The use of a thicker forging provides the extra material necessary to machine the weld bevels after the pressure test is completed and the pup pieces are removed.

The assembly includes an O-ring and bushings which are designed to contain pressure and prevent leaking from inside the LOCK-O-RING® flange.

Maximum travel distance of the hot tap machine must be considered in designing the configuration of the hot tap fitting and valve. This ensures that sufficient travel is available to complete the hot tap and set the guide bar assembly. To complete the tap, the cutter must pass through the components.



LOCK-O-RING® Flow-Through Plug with Guide Bars.

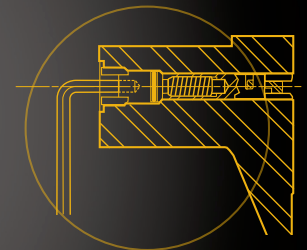

Cross-sectional view of segment screw assembly for the standard LOCK-O-RING® flange.

## Component List:

- Tapping machine adapter
- Hot tap valve
- Hub flange and branch sleeve
- Tapping distance on mainline pipe

The design is identical for the Double-Hub LOCK-O-RING® Flange

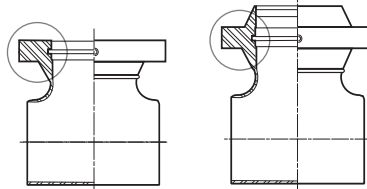

	36" x 24"	36" x 30"	36" x 36"
Tapping Machine Adapter (lost distance)	9"	11"	15"
Valve	48.5"	57"	69.25"
Double-Hub Flange	14.5"	18"	20"
Branch Sleeve	5"	5"	5"
Tapping Distance (on pipeline)	6"	9"	15"
<b>Total Tapping Distance</b>	<b>82.5"</b>	<b>100"</b>	<b>124.5"</b>
TDW Tapping Machine	1200XL	1200XL	2460
<b>Maximum Available Travel</b>	<b>108"</b>	<b>108"</b>	<b>150"</b>
<b>Length Remaining to Insert Pups</b>	25.5"	8"	25.5"

This table provides estimated distances for these components, the maximum travel distance available from the tapping machine and the approximate length remaining to insert pup pieces between the hub flange and the hot tap valve.

NOTE: Actual distances subject to valve specification and fitting design.

\* Registered trademark of T.D. Williamson, Inc. in the United States and in foreign countries. \*\* Trademark of T.D. Williamson, Inc. in the United States and in foreign countries. © Copyright 2011 All rights reserved. T.D. Williamson, Inc.



Pipeline Performance™

T.D. Williamson, Inc.

North and South America: 918-447-5500 · Europe/Africa/Middle East: 32-67-28-36-11  
Asia/Pacific: 65-6364-8520 · UK Swindon: (44) 1-793-603600 Or visit [www.tdwilliamson.com](http://www.tdwilliamson.com)