

# SHORTSTOPP® II 3" x 4" Reduced Branch Plugging Machine

(1" Dia. Control Bar)



T.D. Williamson, Inc.

Data Sheet No. SSII-3x4

Date: September 2004

Supersedes: December 2003

## Tapping

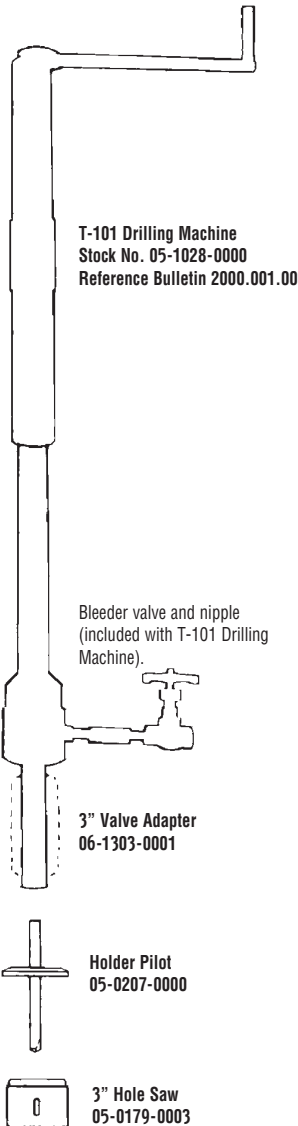

## Plugging

### 3" x 4" Plugging Machine Assembly 08-3501-0304

Includes items below

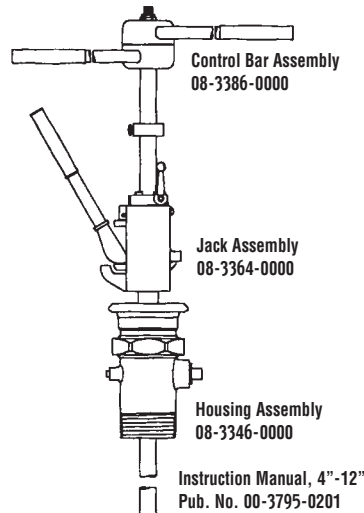

### Standard Plugging Head Assembly 08-3326-0000

Includes items below



Chip Sweep (see Note 3) or Sight Glass  
Sealing Element Not Included (Note 6)

### Bleeder Valve Accessory

Purchased separately

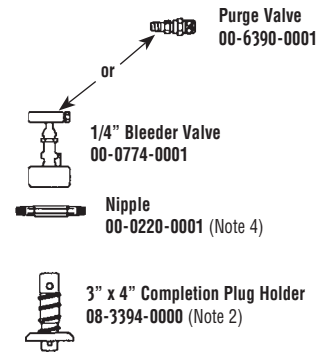

### Sight Glass Kit 08-3423-0000-03

See Sight Glass Data Sheet for details

Carrying case for plugging machine  
sold separately 08-2481-0004

**3" SHORTCUTT® Valve**  
09-0759-0000  
500 psi MWP



**3" x 4" SHORTSTOPP®  
Welding Fitting**  
26-0324-0000 (Note 5)



**3" x 4" 3-WAY™ Tee**  
26-0325-0000-01  
Standard Outlet  
26-0325-0000-02  
Thinwall Outlet  
(Note 3 and Note 5)



Refer to back for fitting options.

## Notes

- Maximum Working Pressure and Temperature:** 150 psi at 100°F or 120 psi at 180°F. Special cups and/or nosepieces may be required (see chart at right). Pressure rating may be limited by valve selection.
- Solid Completion Plug Holder** - 08-3393-0000
- 3" Plugging Head Kit** adapts folding head plugging to plug 3" size-on-size lines and 3-WAY™ Tee Outlet. Kit 08-3421-0000 includes Plugging Head Assembly 08-3314-0000, chip sweep, and control bar adapter.
- Bleeder valve and nipple** are provided with TDW Drilling

Machines.

- Fitting** - Includes threaded completion plug and cap.
- Sealing Elements** - Refer to chart at right.

Pipe ID	150 psi MWP Sealing Element	150 psi MWP Nosepiece
4.188-4.260	08-2332-0004-00	08-3326-0004
4.062-4.125	08-2332-0004-01	08-3326-0004
3.938-4.026	08-2332-0004-02	08-3326-0004
3.750-3.826	08-2332-0004-03	08-3326-0104

Consult factory for unlisted Pipe ID's.



T.D. Williamson, Inc.

Data Sheet No. SSII-3x4

# Fittings

## Tapping and SHORTSTOPP® II Plugging Machine 3" x 4" Gas Main



■ Welding Fitting  
See Bulletin 2100.003.00



■ 3-WAY™ Tee  
See Bulletin 2100.002.00

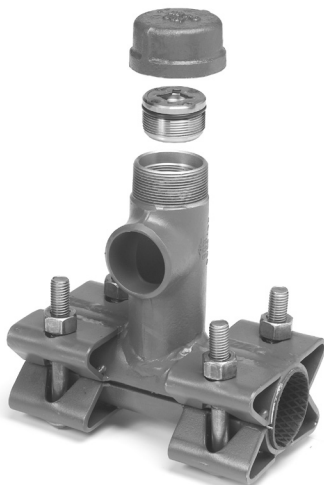

■ Branch Type II 3-WAY™ Tee  
See Bulletin 2100.011



■ Branch Type II Plugging Fitting  
See Bulletin 2100.010

■ Note: Consult your TDW representative for additional fitting options.

Data Sheet No. SSII-3x4