

SHORTSTOPP® II 12" Size-on-Size Plugging Machine

(2-1/2" Dia. Control Bar)



T.D. Williamson, Inc.

Data Sheet No. **SSII-12**

Date: September 2004

Supersedes: December 2003

Data Sheet No. SSII-12

Tapping

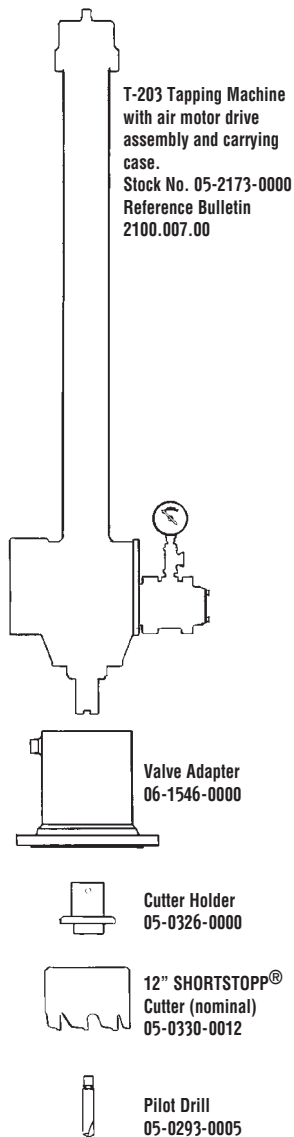

Plugging

12" Plugging Machine Assembly 08-3500-1200

Includes items below

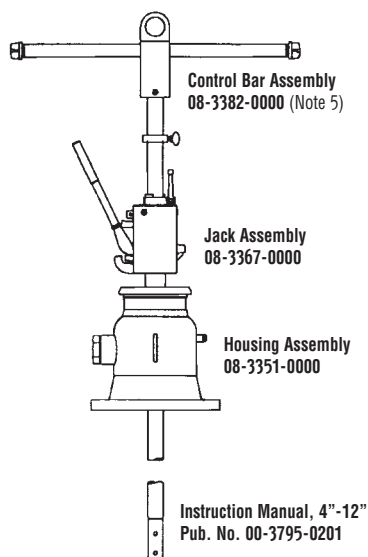

Standard Plugging Head Assembly 08-3322-0000

Includes items below

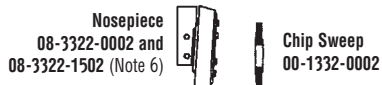

Sealing Element Not Included (Note 6)

Bleeder Valve Accessory

Purchased separately

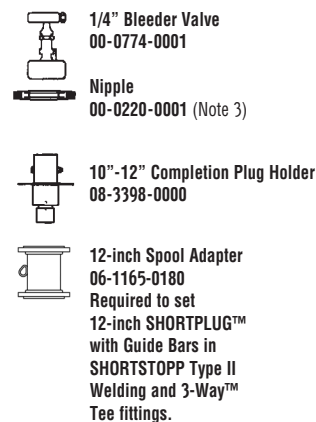

Sight Glass Kit 08-3424-0000-02 (Note 2)

See Sight Glass Data Sheet for details

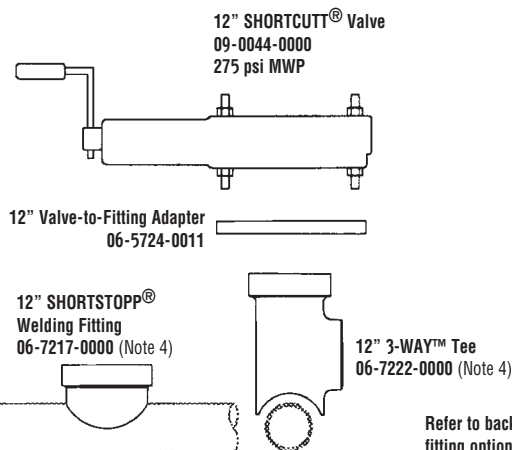

Notes

- Maximum Working Pressure and Temperature:** 60 psi at 180°F with standard plugging head components; 150 psi at 100°F or 120 psi at 180°F, with special cups/nosepieces (see chart at right).
- Sight Glass Kit** - Requires the use of the 12" T-203 Tapping Adapter. Part No. 06-1546-0000.
- Bleeder valve and nipple** are provided with TDW Drilling Machines.
- Fitting** - Leaf-type completion plug and blind flange included.
- 8" x 12" Control Bar Assembly** Part No. 08-3389-0000 may also be used.
- Sealing Elements** - Refer to chart at right.

Pipe ID	60 psi MWP Sealing Element	60 psi MWP Nosepiece	Pipe ID	150 psi MWP Sealing Element	150 psi MWP Nosepiece
12.250-12.311	08-1719-0012-02	08-3322-1502	12.250-12.311	08-3428-0012-02	08-3322-1502
12.062-12.124	08-1719-0012-05	08-3322-1502	12.000-12.061	08-3428-0012-06	08-3322-1502
11.938-12.375	08-0114-0012-00	08-3322-0002	11.938-11.999	08-3427-0012-00	08-3322-0002
11.750-11.811	08-0114-0012-03	08-3322-0002	11.750-11.811	08-3427-0012-03	08-3322-0002

Consult factory for unlisted pipe IDs.



T.D. Williamson, Inc.

Data Sheet No. SSII-12

Fittings

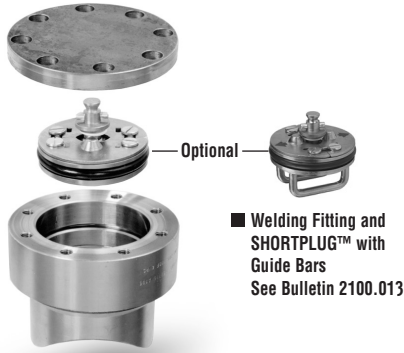

■ Welding Fitting and SHORTPLUG™ with Guide Bars
See Bulletin 2100.013

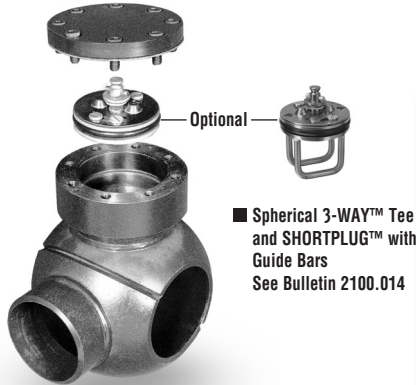

■ Spherical 3-WAY™ Tee and SHORTPLUG™ with Guide Bars
See Bulletin 2100.014



■ 3-WAY™ Tee and SHORTPLUG™ with Guide Bars
See Bulletin 2100.012

■ Welding Fitting
See Bulletin 2100.003

■ Spherical 3-WAY™ Tee
See Bulletin 2100.007

■ 3-WAY™ Tee
See Bulletin 2100.002



■ Mechanical SHORTSLEEVE™ Fitting
See Bulletin 2110.001



■ Branch Type II 3-WAY™ Tee
See Bulletin 2100.011



■ Branch Type II Plugging Fitting
See Bulletin 2100.010

■ Note: Consult your TDW representative for additional fitting options.