

SHORTSTOPP® II 1-1/2-inch Plugging Machine



T.D. Williamson, Inc.

Data Sheet No. **SSII-1-1/2**

Date: December 2010

Supersedes: December 2004

Tapping

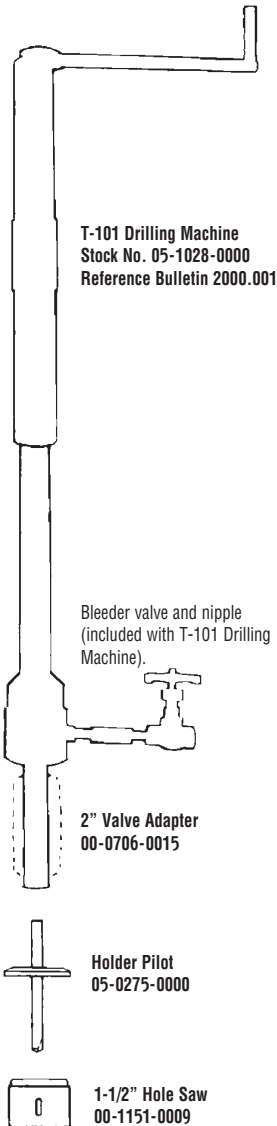

Plugging

1-1/2" Plugging Machine Assembly 08-3305-0000

Includes items below

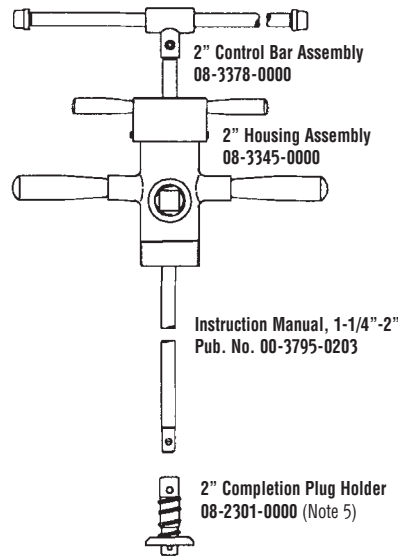

1-1/2" Plugging Head Assembly 08-3304-0000

Includes items below

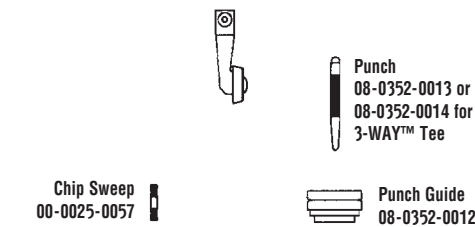

Sealing Element Not Included (Note 6)

Bleeder Valve Accessory

Purchased separately

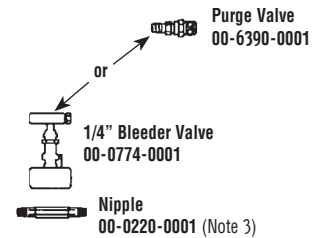

Carrying case for plugging machine
sold separately 08-2481-0006

2" SHORTCUTT® 500 Valve
09-0758-0000
500 psi MWP

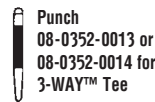

1-1/2" Welding Fitting
26-0211-0000-00 (Note 4)



1-1/2" 3-WAY™ Tee
26-0216-0000-00 (Note 4)



1-1/2" Steel Pipe

Refer to back for fitting options.

Notes

- Maximum Working Pressure:** 200 psi at 100°F (May be limited by valve selection.)
- Maximum Working Temperature:** 180°F at 120 psi.
- Bleeder valve and nipple** are provided with TDW Drilling Machines.
- Fitting** - Includes threaded completion plug and cap.
- Solid Completion Plug Holder** - 08-0367-0001
- Sealing Elements** - Refer to chart at right.

Pipe ID	Part No.
1.562-1.630	08-0114-0015-00
1.500-1.561	08-0114-0015-01

Consult factory for unlisted pipe ID.



T.D. Williamson, Inc.

Data Sheet No. SSII-1-1/2

Fittings

Tapping and *SHORTSTOPP*® II Plugging Machine 1-1/2-inch Gas Main



■ Welding Fitting
See Bulletin 2100.003



■ Spherical 3-WAY™ Tee
See Bulletin 2100.007



■ 3-WAY™ Tee
See Bulletin 2100.002

■ Note: Consult your TDW representative for additional fitting options.