

Sight Glass Assembly for 1-1/4" - 3"

Applications 08-3423-0000-SUFFIX



T.D. Williamson, Inc.

Data Sheet No. SG 1-1/4 - 3

Date: September 2004

Cross Indexing No: See Note 5

Supersedes: December 2003

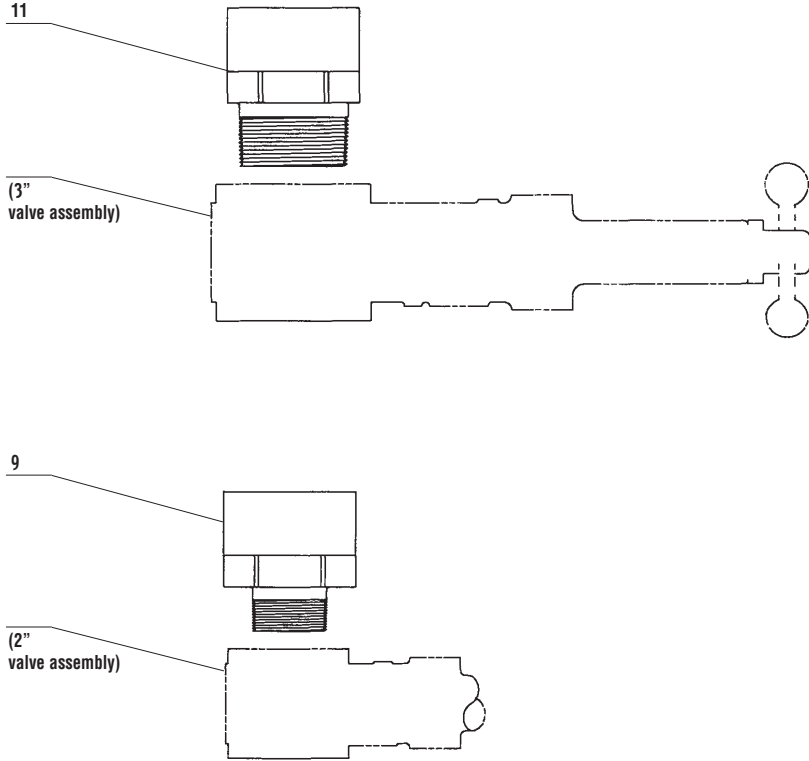
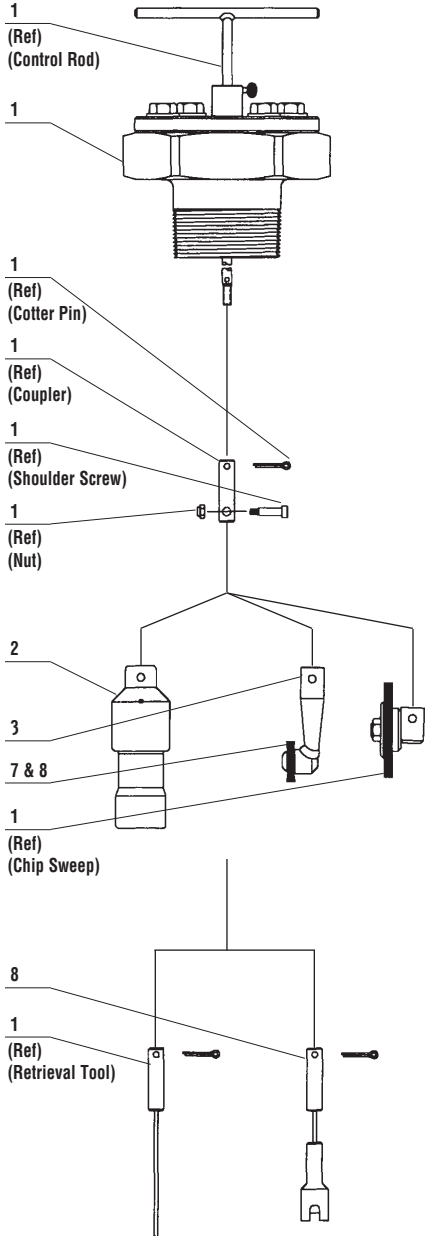

Item	Quantity by Suffix (Note 3)				Description	Part Number
	-03	-02	-01	-00		
1	1	1	1	1	Sight Glass Assembly	08-2340-0000
2	1	1	-	1	Chip Remover Assembly (2"-4")	08-2341-0000
3	-	-	1	1	Plugging Head (1-1/4")	08-0352-0001-01
6	-	-	1	1	Wire Brush (1-1/4")	00-0025-0061
7	-	-	1	1	Button Head Socket Cap Screw	00-0307-0600-05
8	1	1	1	1	Magnet Assembly	08-3426-0000
9	-	1	1	1	Reducer (3" x 2")	08-2340-0004
11	1	-	-	1	Adapter (3")	08-2340-0005

Notes

1. **Maximum Working Pressure:** 500 psi at 100°F
2. **Maximum Working Temperature:** 180°F at 440 psi
3. **Sight Glass Assembly for Inspection/Retrieval with Chip Sweep Only** (no magnets) use Item 1, 08-2340-0000. For 2" applications, Item 9 is also required, 08-2340-0004.
4. **Kit Suffix Number and Pipe Size** - Refer to chart at right.
5. **Cross Indexing Number:** SHORTSTOPP® II Bulletin 2080.001.00; T-101 Bulletin 2000.001.00.

Suffix	Nom. Pipe Size
-00	1-1/4" - 3"
-01	1-1/4" - 1-1/2"
-02	2"
-03	3" - 4"