



# SHORTSTOPP® 60

## Plugging Machines Sizes: 1-1/4" through 12"



T. D. Williamson, Inc.

Bulletin No: 2020.001.00

Date: February 1999

Cross Indexing No: n/a

Supersedes: 601 (3/1/81)



■ **SHORTSTOPP® 60  
Plugging Machine**  
For 2"



■ **SHORTSTOPP® 60  
Plugging Machine**  
For 6"

### Description

The SHORTSTOPP® 60 Plugging Machine is a temporary pipe plugging device which provides an economical, effective way to stop off piping under pressure without shutdown.

It can be used to isolate pipe sections for repairs, additions or replacements, to relocate or extend lines, and to tie in new lines, all without interrupting flow.

### Features

The SHORTSTOPP 60 Plugging Machine is versatile. It can be easily converted to a completion machine by replacing the plugging head with a plug

holder. An 8" (DN 200) plugging machine can stop either 6" (DN 150) or 8" lines by using the applicable size plugging head. A 12" (DN 300) plugging machine can be similarly adapted to stop off both 10" (DN 250) and 12" lines.

Available in sizes 1-1/4" (DN 32) through 12", the SHORTSTOPP 60 Plugging Machine has a maximum operating pressure of 60 psi (4 bar) and a maximum operating temperature of 180°F (82°C).

The plugging machine is easily installed through TDW SHORTCUTT® Valves on SHORTSTOPP® Fittings. These fittings are designed for ASME Class 150 service.

Refer to data sheets.

### ■ Typical Setup

4" (100 mm) through 12" (300 mm)

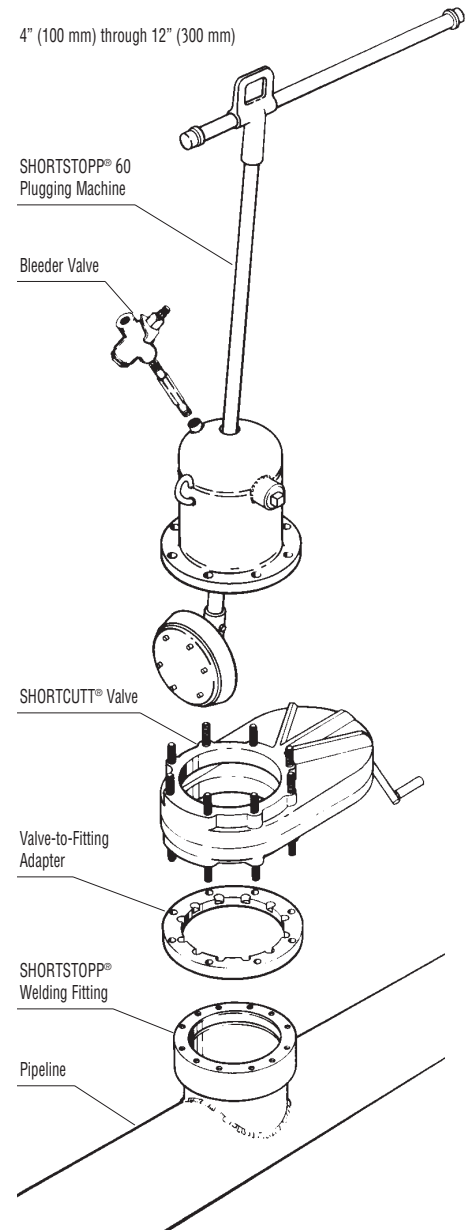

ISO 9001 Certified

Toll Free

**1-888-TDWmSon (839-6766)**



# SHORTSTOPP® 60 Plugging System

## 1-1/4" (DN 32) SHORTSTOPP® Plugging Machine

Description	Part Number	Lbs.	Kg.
2" (50 mm) plugging machine with a 1-1/4" (32 mm) plugging head, chip sweep, completion plug holder, valve adapter, punch and punch guide.	08-0351-0000	6-1/2	3
Without the plugging machine. (Plugging head and other components only for use with 2" machine.)	08-0352-0000	1-1/2	1

## 2" and 3" (DN 50 and DN 80) SHORTSTOPP® Plugging Machine

Description	2" (DN 50)			3" (DN 80)		
	Part Number	Lbs.	Kg.	Part Number	Lbs.	Kg.
Plugging machine with plugging head, chip sweep and completion plug holder.	08-0261-0000	6	3	08-1682-0000	10-1/2	5
Plugging machine with plugging head only.	08-0265-0000	5-1/2	2.5	08-1681-0000	10	5
Completion machine including housing and plug holder assembly with crank throw control bar.	08-0142-0000	6-1/2	3	08-0144-0000	11	5

## Bleeder Valves

Bleeder Valve	00-0774-0001
Nipple	00-0220-0001

Bleeder valves are required for bleeding off trapped pressure.

## 4" through 12" (DN 100 - DN 300) SHORTSTOPP® Plugging Machines

Size	Plugging Machine with Plugging Head and Chip Sweep			*Plugging Head and Chip Sweep only		
	Part Number	Lbs.	Kg.	Part Number	Lbs.	Kg.
4	08-0100-0000	30-1/2	14	--	--	--
6	08-0101-0000	55-1/2	25	08-0326-0000	9	5
8	08-0102-0000	81	37	--	--	--
10**	08-1675-0000	175	79	08-0328-0000	29	13
12	08-0104-0000	191	87	--	--	--

\* This additional equipment, plus adapters, is needed to stop off 6" (150 mm) or 10" (250 mm) lines if you already have an 8" (200 mm) or a 12" (300 mm) plugging machine.

\*\* 10" (250 mm) SHORTCUTT® Valve not available. The 10" SHORTSTOPP® Plugging Machine 08-1675-0000 is equipped with 12" (300 mm) housing for use with 12" SHORTCUTT® Valve and 12" x 10" adapter.

## Components

Completion Plug Holders					Standard Sealing Cups				*Thin Wall Pipe Sealing Cups			
Size		Weight			Minimum I. D.		Maximum I. D.		Maximum I. D.			
Inches	DN	Part Number	Lbs.	Kg.	Part Number	Inches	mm	Inches	mm	Part Number	Inches	mm
1-1/4	32	08-0367-0001	.4	.2	08-0114-0125	1.312	33.3	1.380	35.1	--	--	--
2	50	08-2301-0000	.8	.4	08-0114-0002	2.067	52.5	2.125	54.0	08-0501-0002	2.157	54.8
3	80	08-2302-0000	1	.5	08-0114-0003	3.068	77.9	3.188	81.0	08-0502-0003	3.260	82.8
4	100	08-0121-0000	3	1	08-0114-0004	4.026	102.3	4.188	106.4	08-0502-0004	4.260	108.2
6	150	08-0122-0000	2 3/8	1	08-0114-0006	6.065	154.0	6.313	160.4	08-0502-0006	6.375	161.9
8	200	08-0123-0000	4	2	08-0114-0008	7.981	202.7	8.281	210.3	08-1719-0008	8.500	215.9
10	250	08-0124-0000	5	2	08-0114-0010	10.020	254.5	10.374	263.5	08-1719-0010	10.625	269.9
12	300	08-0125-0000	10	5	08-0114-0012	11.938	303.2	12.374	314.3	08-1719-0012	12.562	319.1

\*Use thin wall cups only when pipe I. D. exceeds the maximum for standard cups.

For adapters, see Bulletin Number 2100.002.00 or 2100.003.00.

For other plugging machine accessories and replacement parts, refer to the SHORTSTOPP® 60 Plugging Machine manual.